

Cleaning and disinfecting a commode for Care Home settings

Best practice is to always:

- Use a bucket or sink designated for only cleaning commodes or bed pans
- Use disposable cleaning cloths and dispose of after use
- Use a pH neutral detergent and warm water for cleaning before disinfecting
- Use 1,000 ppm chlorine-based disinfectant solution, e.g. 50 ml of Milton in 1 litre of cold water after cleaning. If contaminated with blood/blood stained body fluid, use 10,000 ppm, e.g. 100 ml of Milton in 1 litre of cold water, followed by a detergent wipe or detergent and warm water and dried using paper towels
- Ensure commodes are replaced when scratched, stained or rusted

Follow your local 'Safe disposal of waste Policy' for appropriate waste stream to be used.

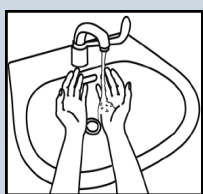

1. Wash hands thoroughly with liquid soap, warm running water, dry with paper towels and dispose of.



2. Put on disposable apron. Wear eye protection if there is a risk of splashing to the eyes.

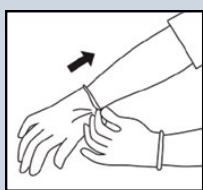

3. Put on disposable gloves.



4. Starting from the top, clean the back rest and arms (remember to clean under the arms).

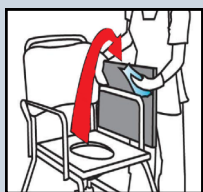

5. Remove the lid and clean the lid of the commode, topside first then underside.



6. Remove the seat, if the design allows, and clean the top then underside.



7. Clean the seat frame, legs, and then foot pedals and wheels if there are any. Dispose of cloth. Then repeat steps 4-7 using the appropriate disinfectant solution. Dispose of cloth.

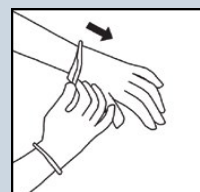

8. Remove gloves (these should be removed before your apron) and dispose of. Clean hands.



9. Remove apron and dispose of.

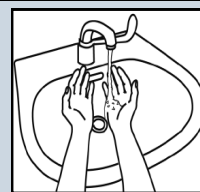

10. Wash hands thoroughly with liquid soap and warm running water.